

INSTALLATION AND SAFETY INSTRUCTIONS HC-558

IMPORTANT SAFETY INSTRUCTIONS

Lighted lamp is HOT!

WARNING: TO REDUCE THE RISK OF FIRE OR INJURY TO PERSONS:

1. Turn off/unplug and allow to cool before replacing lamp.
2. Lamp gets HOT quickly! Contact only switch/plug when turning on.
3. Do not touch hot lens, guard, or housing.
4. Keep lamp away from materials that may burn.
5. Do not touch the lamp at any time. Use a soft cloth. Oil from skin may damage lamp.
6. Do not operate the fixture with a missing or damaged shield.

9223 (Fig. 1)

WARNING: BE SURE ELECTRICITY TO SYSTEM YOU ARE WORKING ON IS TURNED OFF; EITHER THE FUSE REMOVED OR THE CIRCUIT BREAKER IS SET AT OFF.

1. Snap lamp into lamp holder spring by inserting lip on reflector between ears on spring. Insert lamp into socket.
2. Press lamp assembly into housing and push shroud onto housing.
3. Secure with set screw.

9227 (Fig. 2 and 3)

WARNING: BE SURE ELECTRICITY TO SYSTEM YOU ARE WORKING ON IS TURNED OFF; EITHER THE FUSE REMOVED OR THE CIRCUIT BREAKER IS SET AT OFF.

1. Attach lead connectors to lamp terminal screw (FIG. 3).
2. Press lamp assembly into groove in housing and push shroud onto housing (FIG. 2).
3. Secure with set screw.

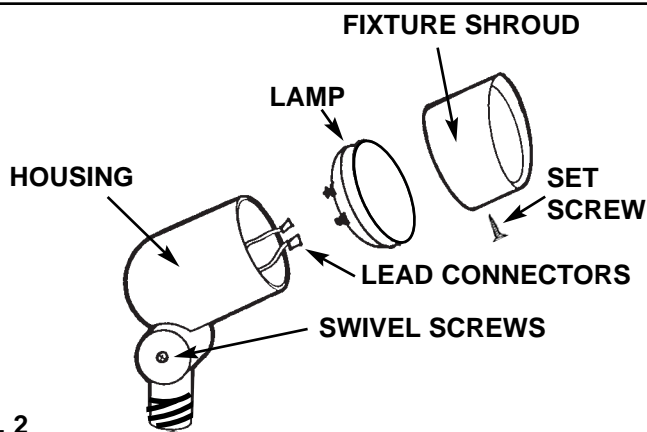

FIG. 2

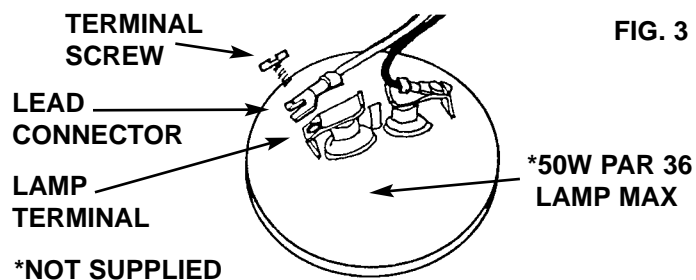
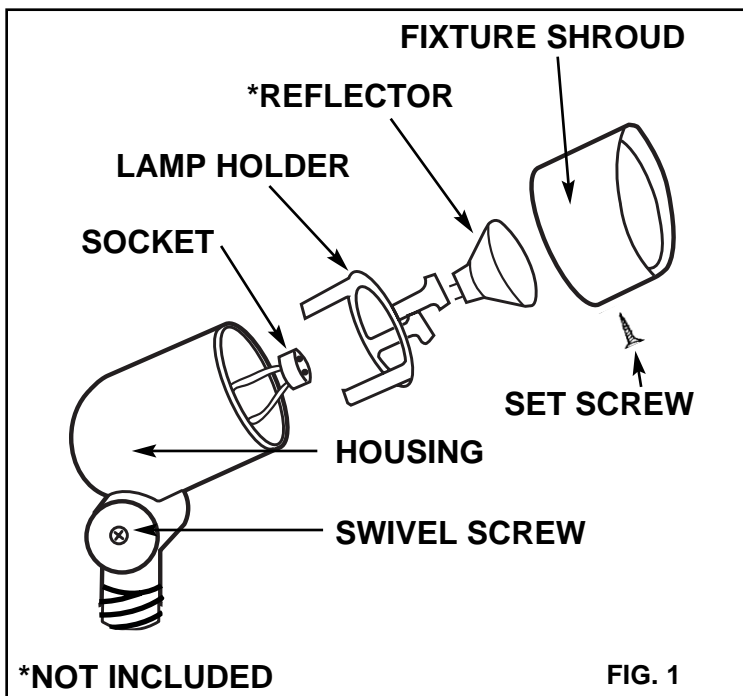

FIG. 3

SEE OTHER SIDE FOR IMPORTANT SAFETY INSTRUCTIONS



***NOT INCLUDED**

FIG. 1



sea gull lighting®
Installation And
Safety Instruction
HC-558 041702

Line art shown may not exactly match the fixture enclosed.
However, the installation instructions do apply to this fixture.
Fill In Item Number On Carton And
File This Sheet For Fixture Reference. ITEM# _____

SURFACE MOUNT INSTALLATION (FIG. 4)

1. Slip low voltage fixture wire through surface mount base (A).
2. Thread fixture with 1/2" male threads to surface mount base (A) (which has 1/2" female threads).
3. Position base (A) on desired surface. Secure with 3 screws (C).
4. Make low-voltage wiring connections.

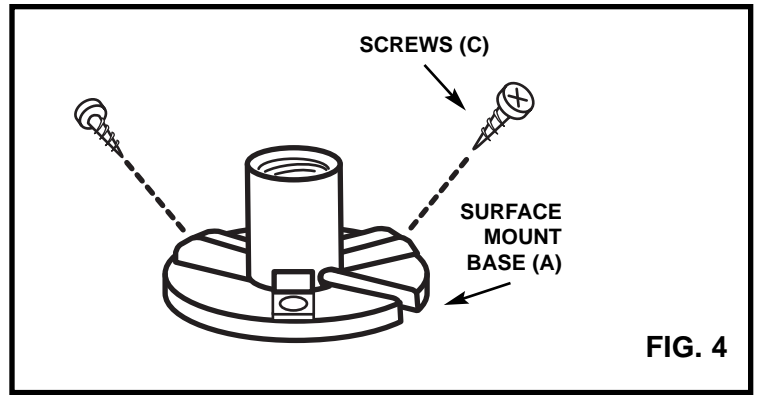

FIG. 4

IN GROUND INSTALLATION (FIG. 5)

1. Place stake (B) into ground by using a spade and then back fill loosely.
2. Thread fixture with 1/2" male threads to surface mount base/cap (A) (which has 1/2" female threads).
3. Slip low voltage fixture wire through surface mount base/cap (A) through the in-ground stake (B) and pull fixture wires above ground.
4. Slip base/cap (A) over stake (B). Aim fixtures at object if applicable. Secure with 3 screws (C).
5. Tamp ground around stake. Make low-voltage wiring connections.

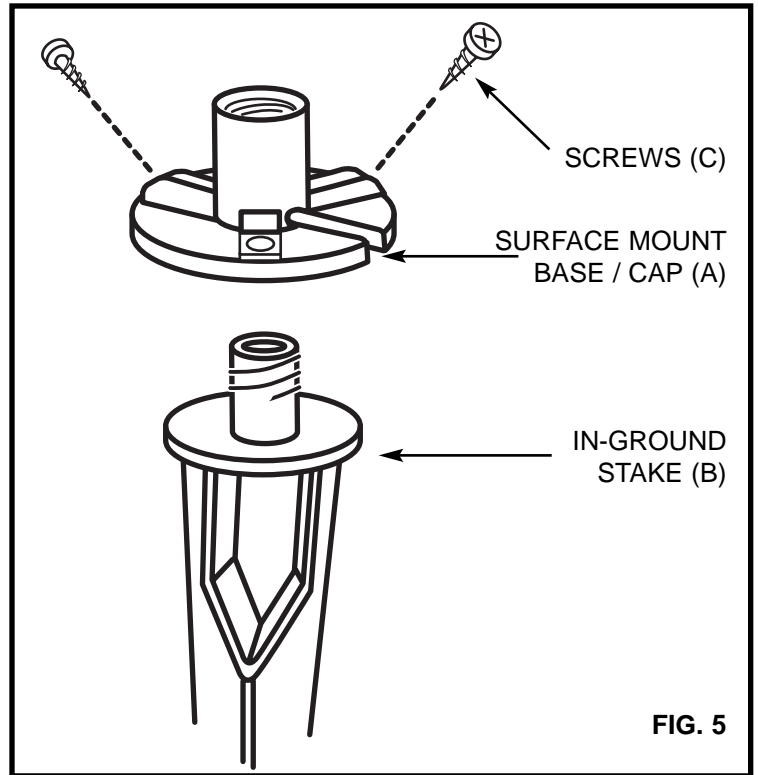

FIG. 5